



AC MOTORS

## SHADED POLE MOTOR

# UNIT BEARING MOTOR

### Applications

Commercial and domestic refrigeration, air conditioning, ventilating, and other application for air movement. Air Over.

### Performance

- Single phase induction motor
- Squirrel cage rotor
- Temperature: -50°C to 85°C.
- Voltage: 127 V, 220 V.
- Frame: Aluminum casting.
- Service: Continuous.
- Hardened steel shaft and lubricated system.
- Thermally Protected or Impedance Protected



Model	Volts	Amperes	HP	Watts	RPM	Rotation	"A"	Price
483-4L-UB/1	127	0.4	1/400	2W	1550	CWLE	3.62	
483-4L-UB/2	127	0.5	1/400	6W	1550	CWLE	3.62	
483-4L-UB/3	127	0.7	1/150	9W	1550	CWLE	3.75	
483-4L-UB/4	127	1.00	1/100	16W	1550	CWLE	4.00	
483-4L-UB/11	220	0.2	1/125	2W	1550	CW	3.62	
483-4L-UB/12	220	0.25	1/40	6W	1550	CW	3.62	
483-4L-UB/13	220	0.35		9W	1550	CW	3.75	
483-4L-UB/14	220	0.50	1/40	16W	1550	CW	4.00	

\*All motors available in opposite rotation

Model	Industry Reference
483-4L-UB/1	Morril: SPB2EM1; Emerson: 102; G.E.: UEM1021, 5109
483-4L-UB/2	Morril: SPB6EM1, SPB6EMR1; Emerson: 117; G.E.: 5311, 5312, 5213
483-4L-UB/3	Morril: SPB9EM1, SPB9EMR1; Emerson: 108 #5991; G.E.: 5411, 5112, 5413, 5KSM81FFL0017
483-4L-UB/4	Morril: SPB16EM1, SPB16EMR1; Emerson: 112; G.E.: 5821, 5822
483-4L-UB/11	
483-4L-UB/12	
483-4L-UB/13	Morril: SPB9EM2, SPB9EMR2; Emerson: 109; G.E.: 5811, 5812
483-4L-UB/14	Morril: SPB16EM2, SPB16EMR2; Emerson: 109; G.E.: 5821, 5822.

### Dimensions

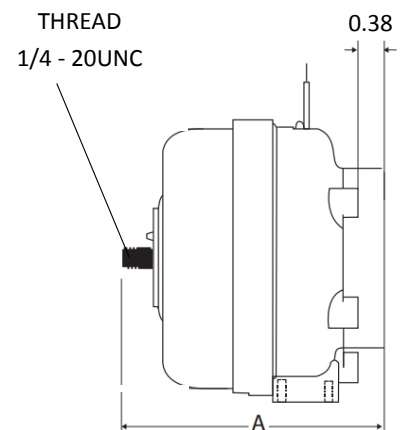
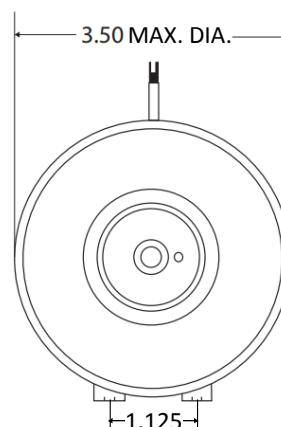

Industria de Motores Eléctricos  
www.imesamotors.com