

## Applications

Designed to meet the severe conditions of farm use, such as manure pumps, barn cleaner, belt drive, conveyors, fans and auger feeders.

## Features

- High Torque
- Single Phase
- Rotation : CW / CCW
- Finish : Black Paint
- Insulation: Class B
- Bearings: Ball Bearings
- Temperature Max. 40°C. Manual Rest Thermal Protection



## Start Capacitor & Split Phase

MODEL	HP	VOLTS	FLA	HZ	RPM	FRAME	APPLICATION	ENCLOSURE	PRICE
448 - 606 / 1	3/4	115 / 208-230	10.8 / 5.3-5.4	60	1725	48NZ	AUGER DRIVE	TEFC	
448 - 606 / 2	1/3	115 / 230	5.3 / 2.7	60	1725	48NY	AUGER DRIVE	TEFC	
456 - 606 / 3	1	115 / 208-230	13.4 / 6.8-6.7	60	1725	56	"AGRICULTURAL FAN"	TEFC	
456 - 606 / 4	1/2	115 / 208-230	8.8 / 4.2-4.4	60	1725	56C	"AGRICULTURAL FAN"	TEFC	
456 - 606 / 5	1	115 / 230	13.4 / 6.7	60	1725	56C	AUGER DRIVE	TEFC	
456 - 606 / 7	3/4	115 / 208-230	8.4 / 4.5-4.2	60	1725/ 1425	56NY	AUGER DRIVE	TEFC	
456 - 606 / 8	1	115 / 208-230	10.8 / 6.0-5.4	60/50	1725/ 1425	56NY	AUGER DRIVE	TEFC	
456 - 606 / 9	1	115 / 208-230	9.2 / 5.3-4.6	60	1725	56	BELT DRIVE FAN	TEAO	
456 - 606 / 10	3/4	115 / 230	9.1 / 4.6	60/50	1725/ 1425	56	AUGER DRIVE	TEFC	
456 - 606 / 11	1/2	115 / 230	8.8 / 4.4	60	1725	56	BELT DRIVE	TEFC	

IMESA	NIDEC/USEM	Marathon	GE	Dayton	Century
448 - 606 / 1	FD34CM2PZY	F1203	F34E1	6K719	C312
448 - 606 / 2	FD13BM2PZYR / FD13CM	HG646	F13E1	HG646 / 6K710	C310
456- 606 / 3	T1CM2JH	F104 / 28AA99	F10E1	1TMY5 / 6K727	C313
456 - 606 / 4	T12CM2J / FD12CM2P	F102 / 28AA97	F12E1	1TMY3 / 6K714	C311
456 - 606 / 5	FD1CM2PZY	F1204	F10E1		
456 - 606 / 7	FD34CM2PZYR	C1293	F203	3K996	C332
456 - 606 / 8	FD1CM2PZY	C1294	F204		C333
456 - 606 / 9				4NXG3 / 4K124	3RCW9
456 - 606 / 10	FD34CM2PZYR			5K046	
456 - 606 / 11	T12CM2J / FD12CM2P			1TMY3	





Single phase

# FARM DUTY

## TECHNICAL SPECS

Includes Shaft Slinger and Gasketed Capacitor Cover

### Item High Torque Farm Duty Motor

Motor Application	Farm Duty
Motor Sub Application	Auger Drive
Motor Design	Capacitor-Start
Motor Enclosure Design	Totally Enclosed Air-Cooled
HP	3/4
Nameplate RPM	1725
Frame	48
Motor Shaft Rotation	CW/CCW
Voltage	115 / 208-230
Full Load Amps	10.8 / 5.3-5.4
Phase	1
Hz	60
Motor Mounting Type	N Flange
Motor Mounting Position	Horizontal
Motor Bearings	Ball
Motor Frame Material	Rolled Steel
Finish	Black Paint
Motor Thermal Protection	Manual
Motor Service Factor	1.00
Max. Ambient Temperature	40 Degrees C
Shaft Dia. (SD)	1/2"
Shaft Length (SL)	1-5/8"
Motor Shaft Design	Flat
Length Less Shaft (LLS)	9-13/16"
Overall Length (OL)	11-7/16"
Ins. Class	F
Capacitor Required	Yes
RPM Range	1701-1800
Duty	Continuous

**MISSING IMAGE**

**Item : 448 - 606 / 1**

## Applications

Designed to meet the severe conditions of farm use, such as manure pumps, barn cleaner, belt drive, conveyors, fans and auger feeders.

## Performance

Keep your farm-duty fans moving with this capacitor-start, farm-duty motor. It features a totally enclosed, fan-cooled motor design to help keep the motor free of contamination. It employs a fan to blow outside over the motor to stay cool, rather than allowing outside air to freely circulate through the interior of the motor. It also features ball bearings and a rolled steel frame for durability and long service life. Includes gasketed conduit box and shaft slinger.

## Dimensions

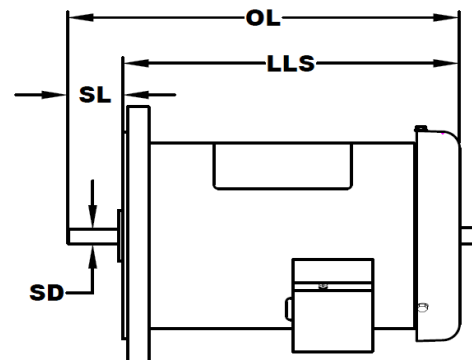

Industria de Motores Eléctricos  
[www.imesamotors.com](http://www.imesamotors.com)



Single phase

# FARM DUTY



## TECHNICAL SPECS

Includes Shaft Slinger and Gasketed Capacitor Cover

Item High Torque Farm Duty Motor

Motor Application	Farm Duty
Motor Sub Application	Auger Drive
Motor Design	Split - Phase
Motor Enclosure Design	Totally Enclosed Fan-Cooled
HP	1/3
Nameplate RPM	1725
Frame	48
Motor Shaft Rotation	CW/CCW
Voltage	115 / 230
Full Load Amps	5.3 / 2.7
Phase	1
Hz	60
Motor Mounting Type	N Flange
Motor Mounting Position	Horizontal
Motor Bearings	Ball
Motor Frame Material	Rolled Steel
Finish	Black Paint
Motor Thermal Protection	Manual
Motor Service Factor	1.15
Max. Ambient Temperature	40 Degrees C
Shaft Dia. (SD)	1/2"
Shaft Length (SL)	1-7/8"
Motor Shaft Design	Flat
Length Less Shaft (LLS)	9.0"
Overall Length (OL)	10-3/4"
Ins. Class	B
Capacitor Required	Yes
RPM Range	1701-1800
Duty	Continuous

**Item : 448 - 606 / 2**

## Applications

Designed to meet the severe conditions of farm use, such as manure pumps, barn cleaner, belt drive, conveyors, fans and auger feeders.

## Performance

Farm-duty motor. It features a totally enclosed to help keep the motor free of contamination. It features ball bearings and a rolled steel frame for durability and long service life.

## Dimensions

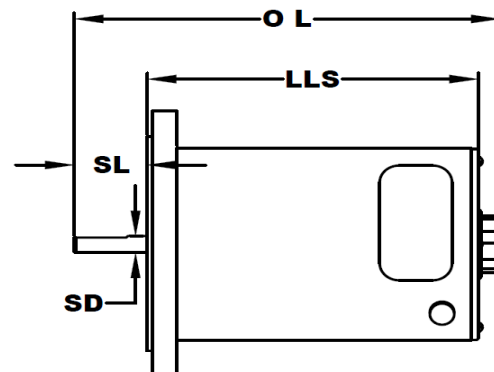

Industria de Motores Eléctricos  
www.imesamotors.com



Single phase

# FARM DUTY



**Item : 456 - 606 / 3**

## TECHNICAL SPECS

Includes Shaft Slinger and Gasketed Capacitor Cover

Item High Torque Farm Duty Motor

Motor Application	Farm Duty
Motor Design	Capacitor-Start
Motor Enclosure Design	Totally Enclosed Fan-Cooled
HP	1
Nameplate RPM	1725
Frame	56
Motor Shaft Rotation	CW/CCW
Voltage	115 / 208-230
Full Load Amps	13.4 / 6.8-6.7
Phase	1
Hz	60
Motor Mounting Type	Rigid Base
Motor Mounting Position	Horizontal
Motor Bearings	Ball
Motor Frame Material	Rolled Steel
Finish	Black Paint
Motor Thermal Protection	Manual
Motor Service Factor	1.15
Max. Ambient Temperature	40 Degrees C
Shaft Dia. (SD)	5/8"
Shaft Length (SL)	2-5/16"
Motor Shaft Design	Keyed
Length Less Shaft (LLS)	10-1/2"
Overall Length (OL)	12-13/16"
Ins. Class	B
Capacitor Required	Yes
RPM Range	1701-1800
Duty	Continuous

## Applications

Designed to meet the severe conditions of farm use, such as manure pumps, barn cleaner, belt drive, conveyors, fans and auger feeders.

## Performance

Keep your farm-duty fans moving with this capacitor-start, farm-duty motor.

It features a totally enclosed, fan-cooled motor design to help keep the motor free of contamination. It employs a fan to blow outside over the motor to stay cool, rather than allowing outside air to freely circulate through the interior of the motor. Its ball bearings and rolled steel frame also help to provide durability and long service life.

## Dimensions

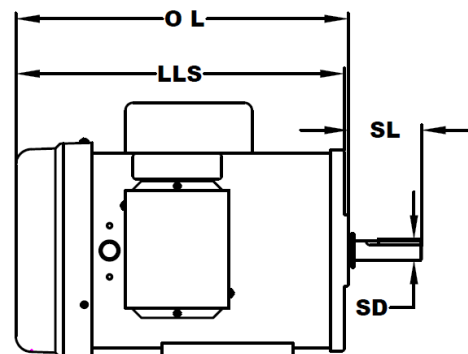

Industria de Motores Eléctricos  
www.imesamotors.com



Single phase

# FARM DUTY



**Item : 456 - 606 / 4**

## TECHNICAL SPECS

Includes Shaft Slinger and Gasketed Capacitor Cover

Item High Torque Farm Duty Motor

Motor Application	Farm Duty
Motor Design	Capacitor-Start
Motor Enclosure Design	Totally Enclosed Fan-Cooled
HP	1/2
Nameplate RPM	1725
Frame	56
Motor Shaft Rotation	CW/CCW
Voltage	115 / 208-230
Full Load Amps	8.8 / 4.2-4.4
Phase	1
Hz	60
Motor Mounting Type	Rigid Base
Motor Mounting Position	Horizontal
Motor Bearings	Ball
Motor Frame Material	Rolled Steel
Finish	Black Paint
Motor Thermal Protection	Manual
Motor Service Factor	1.15
Max. Ambient Temperature	40 Degrees C
Shaft Dia. (SD)	5/8"
Shaft Length (SL)	2-5/16"
Motor Shaft Design	Keyed
Length Less Shaft (LLS)	9-1/2"
Overall Length (OL)	11-13/16"
Ins. Class	B
Capacitor Required	Yes
RPM Range	1701-1800
Duty	Continuous

## Applications

Designed to meet the severe conditions of farm use, such as manure pumps, barn cleaner, belt drive, conveyors, fans and auger feeders.

## Performance

Keep your farm-duty fans moving with this capacitor-start, farm-duty motor.

It features a totally enclosed, fan-cooled motor design to help keep the motor free of contamination. It employs a fan to blow outside over the motor to stay cool, rather than allowing outside air to freely circulate through the interior of the motor. Its ball bearings and rolled steel frame also help to provide durability and long service life.

## Dimensions

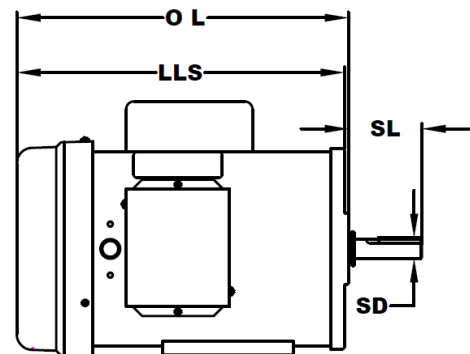

Industria de Motores Eléctricos  
[www.imesamotors.com](http://www.imesamotors.com)



Single phase

# FARM DUTY

## TECHNICAL SPECS

Includes Gasketed Capacitor Cover

Item High Torque Farm Duty Motor

Motor Application	Farm Duty
Motor Sub Application	Auger Drive
Motor Design	Capacitor-Start
Motor Enclosure Design	Totally Enclosed Air-Cooled
HP	1
Nameplate RPM	1725
Frame	56NZ
Motor Shaft Rotation	CW/CCW
Voltage	115 / 230
Full Load Amps	13.4 / 6.7
Phase	1
Hz	60
Motor Mounting Type	N Flange
Motor Mounting Position	Horizontal
Motor Bearings	Ball
Motor Frame Material	Rolled Steel
Finish	Black Paint
Motor Thermal Protection	Manual
Motor Service Factor	1.00
Max. Ambient Temperature	40 Degrees C
Shaft Dia. (SD)	5/8"
Shaft Length (SL)	2.0"
Motor Shaft Design	Keyed
Length Less Shaft (LLS)	10-15/16"
Overall Length (OL)	12-13/16"
Ins. Class	F
Capacitor Required	Yes
RPM Range	1701-1800
Duty	Continuous

MISSING IMAGE

Item : 456 - 606 / 5

## Applications

Designed to meet the severe conditions of farm use, such as manure pumps, barn cleaner, belt drive, conveyors, fans and auger feeders.

## Performance

Keep your farm-duty fans moving with this capacitor-start, farm-duty motor. It features a totally enclosed, fan-cooled motor design to help keep the motor free of contamination. It employs a fan to blow outside over the motor to stay cool, rather than allowing outside air to freely circulate through the interior of the motor. It also features ball bearings and a rolled steel frame for durability and long service life. Includes gasketed conduit box.

## Dimensions

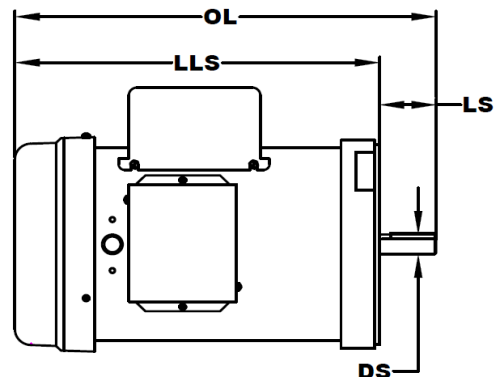

Industria de Motores Eléctricos  
www.imesamotors.com



Single phase

# FARM DUTY

## TECHNICAL SPECS

Includes Gasketed Capacitor Cover

Item High Torque Farm Duty Motor

Motor Application	Farm Duty
Motor Sub Application	Auger Drive
Motor Design	Capacitor-Start
Motor Enclosure Design	Totally Enclosed Fan-Cooled
HP	3/4
Nameplate RPM	1725/1425
Frame	56NY
Motor Shaft Rotation	CW/CCW
Voltage	115 / 208-230
Full Load Amps	8.4 / 4.5-4.2
Phase	1
Hz	60/50
Motor Mounting Type	N Flange
Motor Mounting Position	Horizontal
Motor Bearings	Ball
Motor Frame Material	Rolled Steel
Finish	Black Paint
Motor Thermal Protection	Manual
Motor Service Factor	1.25
Max. Ambient Temperature	40 Degrees C
Shaft Dia. (SD)	1/2"
Shaft Length (SL)	2.00"
Motor Shaft Design	Flat / Keyed
Length Less Shaft (LLS)	10-5/8"
Overall Length (OL)	12-5/8"
Ins. Class	B
Capacitor Required	Yes
RPM Range	1701-1800
Duty	Continuous

MISSING IMAGE

### Item : 456 - 606 / 7

## Applications

Designed to meet the severe conditions of farm use, such as manure pumps, barn cleaner, belt drive, conveyors, fans and auger feeders.

## Performance

Keep your farm-duty fans moving with this capacitor-start, farm-duty motor. It features a totally enclosed, fan-cooled motor design to help keep the motor free of contamination. It employs a fan to blow outside over the motor to stay cool, rather than allowing outside air to freely circulate through the interior of the motor. It also features ball bearings and a rolled steel frame for durability and long service life.

## Dimensions

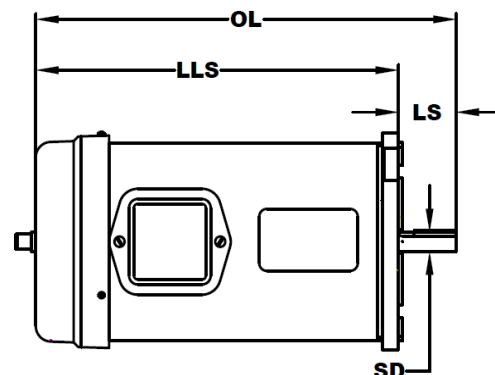

Industria de Motores Eléctricos  
www.imesamotors.com





Single phase

# FARM DUTY

## TECHNICAL SPECS

Includes Gasketed Capacitor Cover

Item High Torque Farm Duty Motor

Motor Application	Farm Duty
Motor Design	Auger Drive
Motor Enclosure Design	Totally Enclosed Fan-Cooled
HP	1
Nameplate RPM	1725 / 1425
Frame	56NY
Motor Shaft Rotation	CW/CCW
Voltage	115 / 208-230
Full Load Amps	10.8 / 6.0-5.4
Phase	1
Hz	60/50
Motor Mounting Type	N Flange
Motor Mounting Position	Horizontal
Motor Bearings	Ball
Motor Frame Material	Rolled Steel
Finish	Black Paint
Motor Thermal Protection	Manual
Motor Service Factor	1.00
Max. Ambient Temperature	40 Degrees C
Shaft Dia. (SD)	5/8"
Shaft Length (SL)	2.00"
Motor Shaft Design	Flat / Keyed
Length Less Shaft (LLS)	11-5/8"
Overall Length (OL)	13-5/8"
Ins. Class	B
Capacitor Required	Yes
RPM Range	1701-1800
Duty	Continuous

MISSING IMAGE

Item : 456 - 606 / 8

## Applications

Designed to meet the severe conditions of farm use, such as manure pumps, barn cleaner, belt drive, conveyors, fans and auger feeders.

## Performance

Keep your farm-duty fans moving with this capacitor-start, farm-duty motor. It features a totally enclosed, fan-cooled motor design to help keep the motor free of contamination. It employs a fan to blow outside over the motor to stay cool, rather than allowing outside air to freely circulate through the interior of the motor. It also features ball bearings and a rolled steel frame for durability and long service life.

## Dimensions

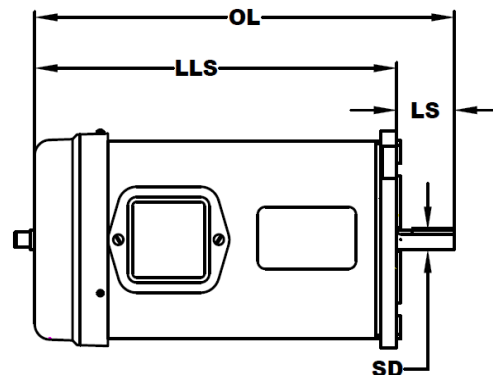

Industria de Motores Eléctricos  
www.imesamotors.com



Single phase

# FARM DUTY

## TECHNICAL SPECS

Includes Shaft Slinger and Gasketed Capacitor Cover

### Item Agricultural Fan Motor

Motor Application	Farm Duty
Motor Sub Application	Poultry / Livestock Belt Drive Fan
Motor Design	Capacitor-Start/Run
Motor Enclosure Design	Totally Enclosed Air-Over
HP	1
Nameplate RPM	1725
Frame	56
Motor Shaft Rotation	CW/CCW
Voltage	115 / 208-230
Full Load Amps	9.2 / 5.3-4.6
Phase	1
Hz	60
Motor Mounting Type	Craled Base
Motor Mounting Position	Horizontal
Motor Bearings	Ball
Motor Frame Material	Rolled Steel
Finish	Black Paint
Motor Thermal Protection	Auto
Motor Service Factor	1.15
Max. Ambient Temperature	40 Degrees C
Shaft Dia. (SD)	5/8"
Shaft Length (SL)	1-7/8"
Motor Shaft Design	Keyed
Length Less Shaft (LLS)	9-15/16"
Overall Length (OL)	11-13/16"
Ins. Class	B
Capacitor Required	Yes
RPM Range	1701-1800
Duty	Continuous



Item : 456 - 606 / 9

## Applications

Designed to meet the severe conditions of farm use, such as manure pumps, barn cleaner, belt drive , conveyors, fans and auger feeders.

## Performance

Move air through your poultry and livestock facility with this belt-drive fan motor.

It features a totally enclosed, air-over design, which allows it to stay cooled by the direct airflow of the fan itself. Because it must be mounted in the airflow of the fan, the motor is designed to resist contamination from dust, moisture, and other airborne particles. It also features a shaft slinger, gasketed capacitor, and conduit box cover for added protection against dirt and moisture help to promote longer service life.

## Dimensions

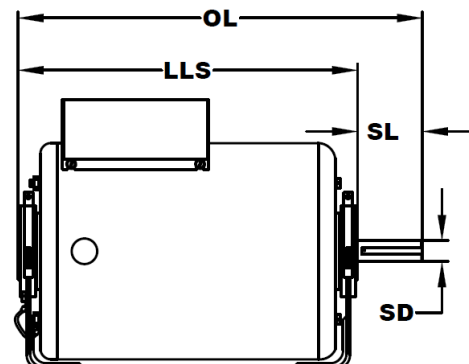

Industria de Motores Eléctricos  
www.imesamotors.com



Single phase

# FARM DUTY



## TECHNICAL SPECS

Includes Gasketed Capacitor Cover

Item Auger Drive Motor

Motor Application	Farm Duty
Motor Sub Application	Auger Drive
Motor Design	Capacitor-Start
Motor Enclosure Design	Totally Enclosed Fan-Cooled
HP	3/4
Nameplate RPM	1725
Frame	56YZ
Motor Shaft Rotation	CW/CCW
Voltage	115/230
Full Load Amps	10.6 / 5.3
Phase	1
Hz	60/50
Motor Mounting Type	Rigid Base
Motor Mounting Position	Horizontal
Motor Bearings	Ball
Motor Frame Material	Rolled Steel
Finish	Black Paint
Motor Thermal Protection	Manual
Motor Service Factor	1.00
Max. Ambient Temperature	40 Degrees C
Shaft Dia. (SD)	1/2"
Shaft Length (SL)	1-3/4"
Motor Shaft Design	Flat
Length Less Shaft (LLS)	10-3/4"
Overall Length (OL)	12-1/2"
Ins. Class	B
Capacitor Required	Yes
RPM Range	1701-1800
Duty	Continuous

**Item : 456 - 606 / 10**

## Applications

Designed to meet the severe conditions of farm use, such as manure pumps, barn cleaner, belt drive, conveyors, fans and auger feeders.

## Performance

Keep your auger moving with this one phase motor. It features a capacitor-start design, with shaft extensions beyond the fan guard for hand cranking.

It features a mounting flange. Its totally enclosed, fan-cooled motor design also helps keep the motor free of contamination. It employs a fan to blow outside over the motor to cool it, rather than allowing outside air to freely circulate through the interior of the motor.

## Dimensions

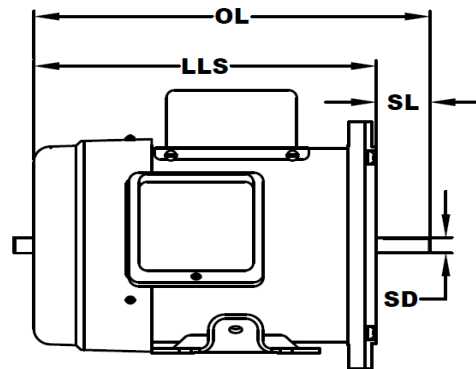

Industria de Motores Eléctricos  
www.imesamotors.com



Single phase

# FARM DUTY



**Item : 456 - 606 / 11**

## TECHNICAL SPECS

Includes Shaft Slinger and Gasketed Capacitor Cover

Item High Torque Farm Duty Motor

Motor Application	Farm Duty
Motor Design	Capacitor-Start
Motor Enclosure Design	Totally Enclosed Fan-Cooled
HP	1/2
Nameplate RPM	1725
Frame	56
Motor Shaft Rotation	CW/CCW
Voltage	115/230
Full Load Amps	8.8/4.4
Phase	1
Hz	60
Motor Mounting Type	Rigid Base
Motor Mounting Position	Horizontal
Motor Bearings	Ball
Motor Frame Material	Rolled Steel
Finish	Black Paint
Motor Thermal Protection	Manual
Motor Service Factor	1.15
Max. Ambient Temperature	40 Degrees C
Shaft Dia. (SD)	5/8"
Shaft Length (SL)	2-5/16"
Motor Shaft Design	Keyed
Length Less Shaft (LLS)	9-15/16"
Overall Length (OL)	11-13/16"
Ins. Class	B
Capacitor Required	Yes
RPM Range	1701-1800
Duty	Continuous

## Applications

For use in high-torque installations, such as conveyors, silo unloaders, barn cleaners, compressors, and manure pumps, this motor is designed to be durable and powerful.

## Performance

The high-torque design enables it to start under heavy load conditions. A capacitor cover and gasketed conduit box. Shaft slinger included.

The totally enclosed fan-cooled motor design also helps keep the motor free of contamination. It employs a fan to blow outside over the motor to stay cool, rather than allowing outside air to freely circulate through the interior of the motor.

## Dimensions

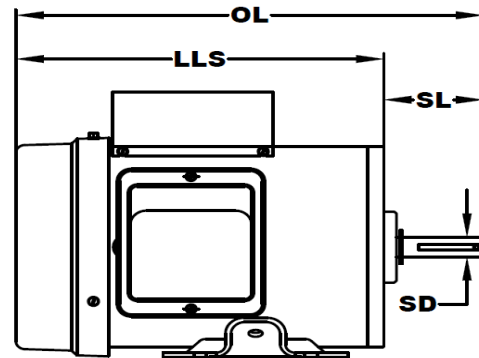

Industria de Motores Eléctricos  
[www.imesamotors.com](http://www.imesamotors.com)